



Lifestyle Automation

Touch Lamina

Glass

OPERATION MANUAL

Version TLUSA01.02

Table of Contents

Introduction

Introduction to the Touch Lamina® Glass
Electrical specifications

Instructions

Installation instructions

Pairing the Touch Lamina®

Pairing the Touch Lamina® with the Silux Control® network (IntelliHub®)
Pairing the Touch Lamina® as direct connect
How to delete (unpair) paired Silux Control® devices
How to control a Silux Control® device
Factory reset

Warranty & Support

1. Troubleshooting
2. Warranty
 - I. What this warranty covers
 - II. What period does this warranty cover
 - III. What Silux Control® will do to correct any problems
 - IV. What is not covered by this warranty
3. Support
4. Disclaimer of liability

Introduction

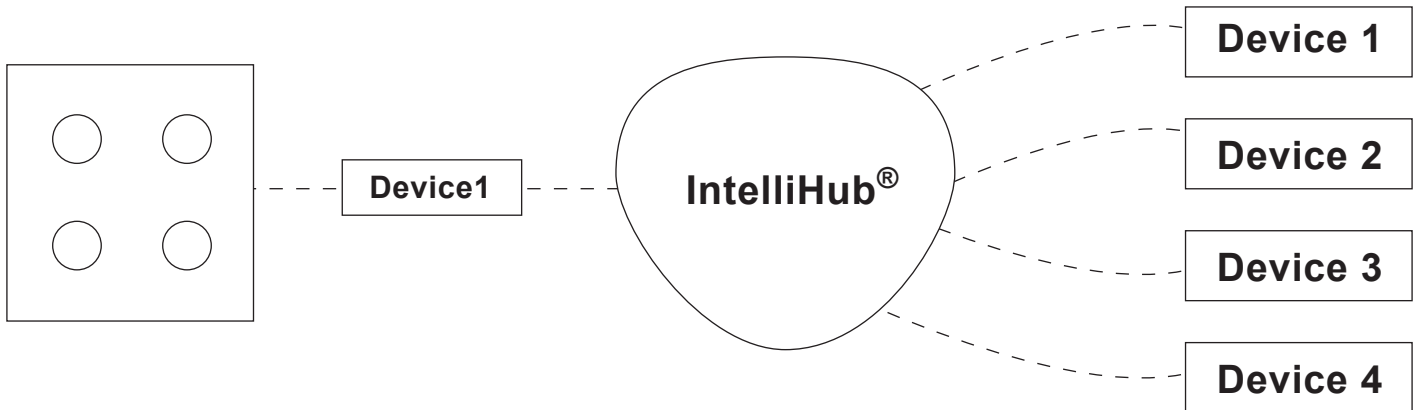

Introduction to the Touch Lamina®

The Touch Lamina® is one of the many useful and wonderful products that form part of the Silux Control® automation series. The purpose of this product is to control your lights or any other Silux Control® device with the touch of a button. All you need to do is pair the Touch Lamina® to your Silux Control® product you wish to control.

Please note: There are 2 ways to pair your devices:

1. Network pairing - This enables you to connect a button to the Silux Control® network, to control any device on the network, and to be used with more than one device. Use this option if you wish to make use of the intelligence of the network to control a device which is located far away from your Touch Lamina®, control more than one device at a time or if you would like your button governed by times or duration.
2. Direct pairing - Direct pairing is used when you wish to control a single in-range device with a single button, for example, using the Touch Lamina® in the lounge only to control lights in the lounge.

Electrical specifications

Input	3V (2 x CR2032 batteries)
Operating Temperature	0 °C ~ 40 °C 10% ~90% RH
Storage Temperature	-10 °C ~ -70 °C 5% ~90% RH
Pairing	<ul style="list-style-type: none">• Silux Control® network• Direct connect
Network	Silux Control® RF proprietary encrypted
RF Range	50m open air & meshing
Radio Frequency	868MHZ (Adjustable frequency to meet different county legislations)
Encryption	Silux Control® RF proprietary meshing
Language	English, others coming soon
OS	Android 4.0+, iOS 8.0+, Windows 7+
App	Silux Control® can be integrated with other automation features of Silux Control®.

IF YOU FEEL UNCOMFORTABLE OR YOU ARE UNFAMILIAR WITH HOUSEHOLD ELECTRICAL WIRING, WE RECOMMEND THAT YOU USE A QUALIFIED ELECTRICIAN TO INSTALL THESE PRODUCTS FOR YOU.

Instructions

Before continuing with installing and pairing the device, please ensure that your Silux Control® app is installed and registered and your IntelliHub® is paired if using network pairing. (Please refer to the IntelliHub® OPERATION MANUAL).

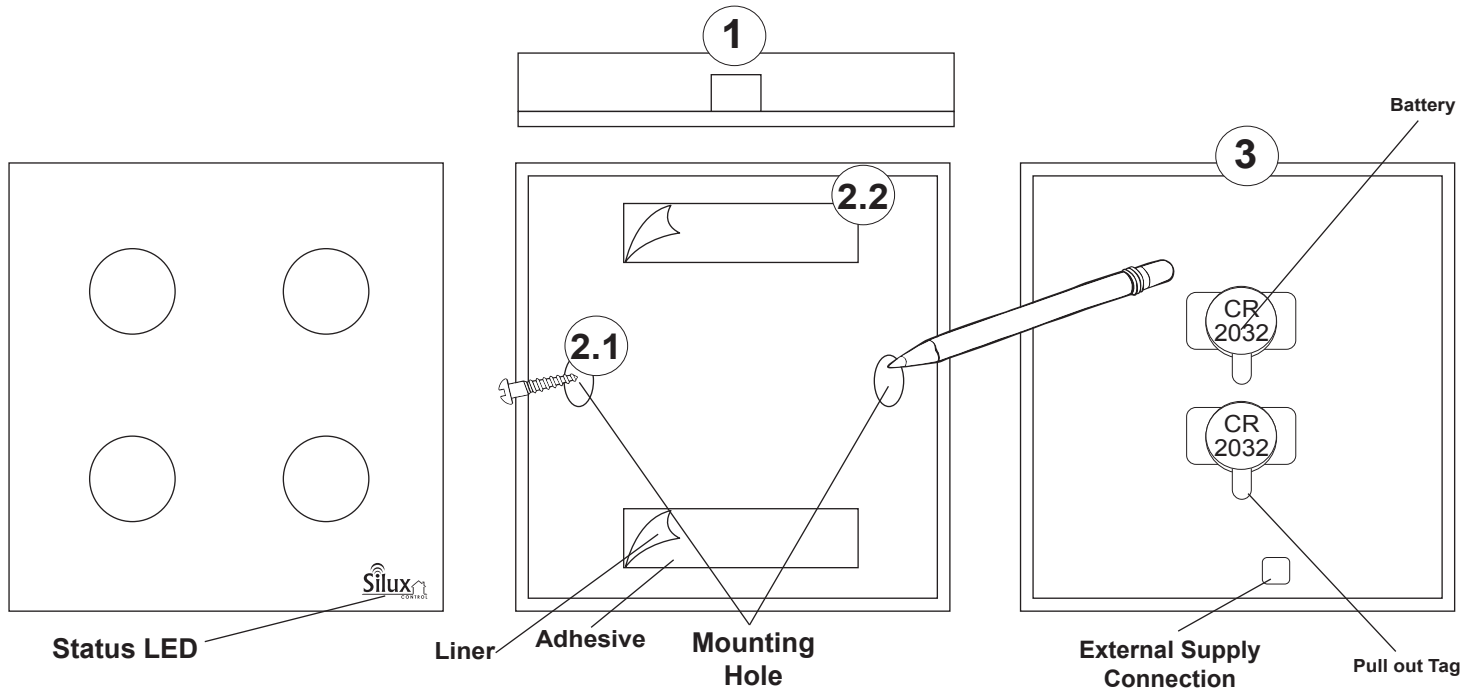

I. Installing the Touch Lamina®:

Step 1. Open the plastics by inserting & twisting a small flat screwdriver into the outer clip located either at the bottom or top of the Touch Lamina®.

Step 2.1. If using screws which are supplied, use the back plastic to mark with a pencil or pen where your holes are going to be. Drill holes in the wall, push the plugs in and mount the backside plastic against the wall using the screws supplied.

Step 2.2. If using the double sided tape supplied, remove the first liner of the tape, apply the tape to the backside plastics and let the adhesive set before you try and remove the second liner. Place the backside firmly against the wall where you would like your Touch Lamina® to be positioned and let it set.

Step 3. Pull out the tags from beneath the batteries. The Touch Lamina® will now be powered on. Please refer to "How to pair with Silux Control® devices".

Step 4. Clip the Touch Lamina® cover back over the plastic on the wall to mount it.

Replacing the CR2032 3V batteries:

There will be two CR2032 batteries supplied with the product. The batteries will have a life span of 1-2 years, depending on how often the Touch Lamina® is used.

Step 1. Open the plastics by inserting & twisting a small flat screwdriver into the outer clip located either at the bottom or top of the Touch Lamina®.

Step 2. Slide out the old CR2032 batteries and replace it with the new CR2032 batteries. The Touch Lamina® will now be powered on.

Step 3. Clip the Touch Lamina® cover back over the plastics on the wall to mount it.

Please Note: It's not necessary to pair the Silux Control® devices again after replacing the batteries.

Pairing the Touch Lamina®

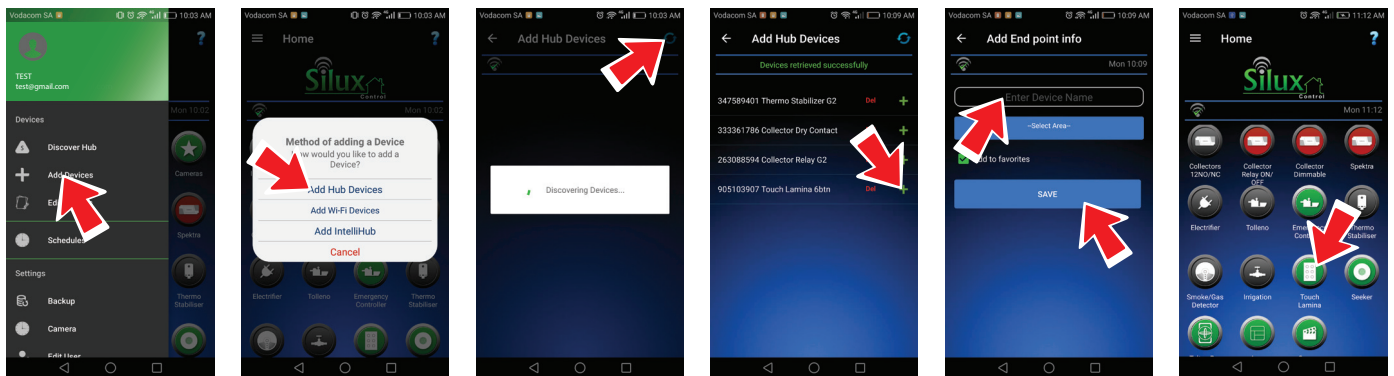

Pairing the Touch Lamina® with Silux Control® Devices via network pairing

Step 1. Locate the teach button on the Silux Control® device you wish to control and press it.

Please note: After pressing the teach button you have 30 seconds to pair the devices.

Step 2. Locate the teach button on the Touch Lamina® and press it once. The teach light will flash slowly.

Step 3. Select the button on the front of your Touch Lamina® to make sure it is discoverable on the network.

Step 4. Open your Silux Control® app and, in the dropdown menu, tap "Add device".

Step 5. Look for the Touch Lamina® in the list of devices using its serial number. (Located on the sticker on the bottom of the Touch Lamina® plastics, or on the Touch Lamina® packaging)

Step 6. Tap the "+" button and fill in the required details.

Step 7. Tap "Save". The Touch Lamina® will be available to link to Silux Control® devices or schedules.

Pairing the Touch Lamina® with Silux Control® Devices as Direct Pairing

Step 1. Locate the teach button on the Silux Control® device and press it.

Please note: After pressing the teach button you have 30 seconds to pair the devices.

Step 2. Locate the teach button on the Touch Lamina® and press it twice. The teach light will flash faster.

Step 3. Select the button on the front you wish to control your device with.

Step 4. Once the teach light stops flashing on both your Touch Lamina and Silux Control® device, the selected button will be paired.

Step 5. To program another button on the Touch Lamina®, repeat the above process.

How to delete (unpair) paired Silux Control® devices:

To delete a Silux Control® device from the Touch Lamina®, both the Touch Lamina® and device needs to be on.

1. Press the teach button on the Silux Control® device you wish to unpair.

2. Press the teach button on the Touch Lamina® three times. The light will start flashing.

3. Press the button on the Touch Lamina® front panel you wish to unpair or delete, the teach light will go solid then start flashing again.

5. You can then tap the next button on the front panel of the Touch Lamina® you wish to unpair/delete and repeat the above process. Once both lights have stopped flashing, your device will be unpaired.

If the light stays on for 30 seconds the unpairing was unsuccessful.

How to control a Silux Control® device:

Once the Touch Lamina® is paired to a device, the device can be controlled by touching a button previously paired. The Touch Lamina® can also dim a device by tapping and holding the corresponding button. You are able to pair up to 6 Touch Lamina® buttons to one Silux Control® device.

Please note: The Collector® controlling the device has to be the Collector® Dimmable to be able to dim.

Warranty & Support

1. Troubleshooting

Please visit our website at www.siluxcontrol.com/FAQ for a detailed list of all the Frequently Asked Questions.

- Ensure that the power going to the device is on.
- Ensure you have the latest app installed on your device and that you're connected to your local network.
- Ensure that your IntelliHub® is on and connected to your local network.
- Ensure that this device is added to your device list when using the app.
- Ensure that you have the correct device selected when using the app.

2. Warranty

I. What this warranty covers:

Silux Control® warrants to the original purchaser of this Silux Control® product that the product shall be free from defects in design, assembly, material or workmanship under normal use and operation.

Silux Control®'s sole and exclusive obligation under the foregoing warranty shall be to repair or replace, at its option, any defective product that fails during the warranty period. The expense of removal and re-installation of any item is not included in this warranty.

WARNING: Silux Control® and its distributors and resellers cannot be held responsible for any damages this product might have caused including 3rd party damages.

II. What period does this warranty cover:

Silux Control® warrants this product for 12 months.

III. What Silux Control® will do to correct any problems:

Silux Control® will repair or replace, at its option, any defective product free of charge (excluding shipping charges for this product).

Silux Control® reserves the right to discontinue any of its products without notice and disclaims any limited warranty to repair or replace any such discontinued products.

IV. What is not covered by this warranty

Upon claiming this warranty, all above warranties are null and void if the purchased Silux Control® product is not returned for an authorized inspection, at the sole expense of the purchaser, or if Silux Control® determines that the Silux Control® product has been improperly installed, altered in any way or opened/tampered with. The Silux Control® product warranty does not protect against instances of uncontrollable natural disasters such as flood, lightning, earthquake, war, vandalism, theft, normal use wear and tear, erosion, depletion, obsolescence, physical damage, water damage, damage due to low voltage disturbances (i.e. brownouts or sags), non-authorized program or system equipment modification /alteration.

3. Support

Please visit our website at www.siluxcontrol.com for any other support, products, future products, and updated user manuals.

4. Disclaimer of Liability

Please read this user manual thoroughly before using Silux Control® products. Follow all safety precautions when installing this product. It is always recommended to use a qualified electrician.

Under no circumstances shall Silux Control® or its associates be liable for any direct, indirect, incidental, special or consequential damage that results from the use of or inability to use the Silux Control® products. By using any Silux Control® automation products, you expressly agree that the use of these products are at own risk. Neither Silux Control® nor its affiliates, subsidiaries, or designees nor each of their respective officers, directors, employees, agents, third party content providers, designers, contractors, distributors, merchants, sponsors or licensors can be held responsible for any injury, death or damages this product might have caused.